

Z-Maß-Katalog

Rohrleitungssysteme / Rohrverbindungstechnik

Rotguss-Gewindefittings

03.12/2015

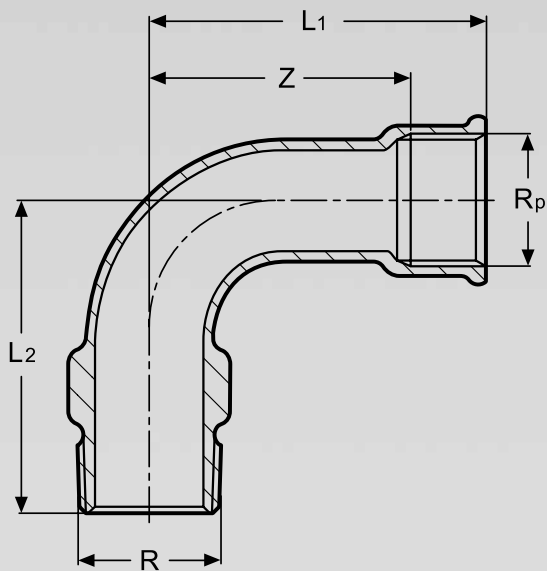

Gewindefittings aus Rotguss

Gewinde nach DIN EN 10226 (alt DIN 2999), Teil 1, zugelassen für die Trinkwasserinstallation nach DIN 1988 und die Gasinstallation nach TRGI, mit DVGW-Prüfzeichen DV-7401 AO 2957.

Installationssystem für Trinkwasser- und Heizungsinstallationen, mit Kupferrohren nach DIN EN 1057 und DVGW-Arbeitsblatt GW 392 und Pressverbindern aus Kupfer oder Rotguss.

Sicherheit in Verbindung mit hohem Schutz vor Korrosionsschäden bei ungleichen Wassereigenschaften, unter schwierigen äußeren Bedingungen und bei der Erdverlegung.

Hinweis

Abbildungen, Maßangaben und Hinweise in diesem Dokument sind unverbindlich. Änderungen sind jederzeit möglich, auch ohne dies besonders bekanntzugeben.

Bitte rufen Sie vor jeder Verwendung die aktuellen Z-Maße aus dem Internet ab.

»www.viega.de« – Navigationsbereich »Produkte«

Viega-Service

Viega GmbH & Co. KG

Postfach 4 30/4 40

DE-57428 Attendorn

Technische Beratung

Telefon: 02722 61 1100

Telefax: 02722 61 1101

service-technik@viega.de

Planungssoftware

Telefon: 02722 61 1700

Telefax: 02722 61 1701

service-software@viega.de

info@viega.de

Internet

www.viega.de

Inhaltsverzeichnis nach Produktnamen

| | |
|---|----|
| Winkel 90° (IG) | 6 |
| Winkel 90° (IG) | 6 |
| Winkel 90° (AG/IG) | 6 |
| Winkel 90° (AG/IG) | 6 |
| Winkel 90° (AG) | 7 |
| Winkel 45° (IG) | 7 |
| Winkel 45° (AG/IG) | 7 |
| Bogen 90° (AG/IG – Mehrkant) | 7 |
| Bogen 90° (AG – Mehrkant) | 8 |
| Etagenbogen (AG/IG) | 8 |
| Wandscheibe (IG) | 8 |
| Wandscheibe (IG) | 8 |
| T-Stück (IG) | 9 |
| Kreuzstück (IG) | 9 |
| Muffe (IG) | 9 |
| Muffe (Red./IG) | 10 |
| Nippel | 10 |
| Doppelnippel (AG – Mehrkant) | 10 |
| Reduziernippel (AG – Mehrkant) | 11 |
| Reduziernippel (AG/IG – Mehrkant) | 11 |
| Reduziernippel (AG/IG – Mehrkant) | 11 |
| Gewindestutzen (AG – Mehrkant) | 12 |
| Gewindestutzen (AG – Mehrkant) | 12 |
| Reduzierstück (AG/IG – Mehrkant) | 13 |
| Reduzierstück (AG/IG) | 13 |
| Langnippel (AG) | 14 |
| Langnippel (AG) | 15 |
| Langnippel (Innenvielkant) | 15 |
| Hahnverlängerung (Innenvielkant) | 16 |
| Rohrverschraubung (AG – flachdichtend) | 17 |
| Rohrverschraubung (AG – konischdichtend) | 17 |
| Rohrverschraubung (IG – flachdichtend) | 17 |
| Rohrverschraubung (IG – konischdichtend) | 17 |
| Rohrverschraubung (AG/IG – flachdichtend) | 18 |
| Rohrverschraubung (AG/IG – konischdichtend) | 18 |
| Winkelverschraubung (AG/IG – konischdichtend) | 18 |
| Winkelverschraubung (AG/IG – flachdichtend) | 18 |
| Verschraubung (AG – flachdichtend) | 19 |
| Flansch PN 16 (IG) | 19 |
| Stopfen (AG – Vierkant) | 19 |
| Stopfen (AG – Vierkant) | 20 |
| Kappe (IG – Mehrkant) | 20 |
| Bauelement (mit Stopfen) | 20 |

| Art.-Nr. | Seite | Art.-Nr. | Seite | Art.-Nr. | Seite | Art.-Nr. | Seite | Art.-Nr. | Seite |
|--------------|-----------|--------------|-----------|--------------|-----------|--------------|-----------|--------------|-----------|
| 145 804..... | 18 | 267 339..... | 14 | 271 893..... | 10 | 319 243..... | 15 | 320 423..... | 13 |
| 148 041..... | 18 | 267 346..... | 14 | 271 916..... | 9 | 319 250..... | 15 | 320 430..... | 13 |
| 259 778..... | 8 | 267 353..... | 14 | 271 930..... | 9 | 319 267..... | 15 | 320 614..... | 9 |
| 264 000..... | 6 | 267 377..... | 14 | 281 717..... | 6 | 319 274..... | 15 | 320 621..... | 9 |
| 264 024..... | 6 | 267 384..... | 14 | 281 748..... | 6 | 319 281..... | 15 | 320 638..... | 9 |
| 264 048..... | 6 | 267 391..... | 14 | 281 755..... | 7 | 319 298..... | 15 | 320 645..... | 7 |
| 264 109..... | 6 | 267 407..... | 14 | 281 809..... | 9 | 319 304..... | 15 | 320 652..... | 7 |
| 264 123..... | 6 | 267 414..... | 14 | 281 823..... | 13 | 319 311..... | 15 | 320 669..... | 6 |
| 264 147..... | 6 | 267 421..... | 14 | 281 847..... | 19 | 319 328..... | 15 | 320 676..... | 6 |
| 264 161..... | 7 | 267 438..... | 14 | 281 854..... | 20 | 319 335..... | 15 | 320 683..... | 6 |
| 264 185..... | 7 | 267 445..... | 14 | 282 103..... | 10 | 319 342..... | 15 | 320 690..... | 7 |
| 264 208..... | 7 | 267 520..... | 10 | 282 127..... | 11 | 319 359..... | 15 | 321 680..... | 11 |
| 264 222..... | 9 | 267 544..... | 10 | 282 349..... | 9 | 319 366..... | 15 | 321 697..... | 11 |
| 264 246..... | 9 | 267 568..... | 13 | 282 356..... | 10 | 319 526..... | 11 | 321 710..... | 6 |
| 264 260..... | 9 | 267 582..... | 13 | 282 363..... | 17 | 319 618..... | 19 | 321 727..... | 9 |
| 264 284..... | 9 | 267 605..... | 13 | 282 370..... | 18 | 319 625..... | 19 | 321 734..... | 9 |
| 264 307..... | 9 | 267 629..... | 13 | 282 400..... | 14 | 319 632..... | 19 | 321 741..... | 10 |
| 264 321..... | 9 | 267 643..... | 13 | 282 417..... | 14 | 319 649..... | 15 | 321 758..... | 19 |
| 264 420..... | 9 | 267 667..... | 13 | 282 424..... | 14 | 319 656..... | 15 | 321 765..... | 13 |
| 264 444..... | 9 | 267 681..... | 13 | 282 431..... | 14 | 319 663..... | 15 | 321 772..... | 13 |
| 264 468..... | 9 | 267 704..... | 13 | 282 448..... | 14 | 319 670..... | 15 | 321 789..... | 10 |
| 266 356..... | 10 | 267 728..... | 13 | 282 455..... | 14 | 319 687..... | 15 | 321 796..... | 6 |
| 266 363..... | 10 | 267 742..... | 13 | 282 462..... | 14 | 319 694..... | 14 | 321 840..... | 13 |
| 266 370..... | 10 | 267 766..... | 9 | 294 571..... | 7 | 319 700..... | 14 | 321 857..... | 13 |
| 266 394..... | 10 | 267 780..... | 9 | 294 595..... | 7 | 319 717..... | 14 | 321 864..... | 13 |
| 266 417..... | 10 | 268 190..... | 19 | 294 618..... | 7 | 319 724..... | 14 | 321 871..... | 13 |
| 266 431..... | 10 | 268 213..... | 19 | 294 632..... | 8 | 319 731..... | 15 | 321 888..... | 13 |
| 266 455..... | 13 | 268 237..... | 19 | 294 656..... | 8 | 319 748..... | 15 | 322 076..... | 10 |
| 266 462..... | 13 | 268 305..... | 20 | 294 670..... | 8 | 319 755..... | 14 | 322 083..... | 10 |
| 266 479..... | 13 | 268 329..... | 20 | 296 643..... | 8 | 319 762..... | 14 | 322 090..... | 10 |
| 266 486..... | 13 | 268 343..... | 20 | 296 667..... | 8 | 319 779..... | 14 | 322 106..... | 10 |
| 266 493..... | 13 | 268 367..... | 20 | 317 089..... | 13 | 319 786..... | 15 | 322 113..... | 10 |
| 266 509..... | 13 | 268 862..... | 10 | 317 959..... | 6 | 319 793..... | 15 | 322 120..... | 10 |
| 266 516..... | 13 | 268 879..... | 10 | 317 966..... | 7 | 319 809..... | 15 | 322 137..... | 10 |
| 266 523..... | 11 | 269 098..... | 10 | 317 973..... | 7 | 319 816..... | 15 | 322 144..... | 10 |
| 266 530..... | 11 | 269 111..... | 10 | 317 980..... | 7 | 319 823..... | 15 | 322 151..... | 20 |
| 266 547..... | 11 | 269 135..... | 10 | 317 997..... | 7 | 319 830..... | 15 | 322 168..... | 20 |
| 266 554..... | 9 | 269 159..... | 11 | 318 000..... | 6 | 319 847..... | 15 | 322 175..... | 20 |
| 266 561..... | 9 | 269 173..... | 11 | 318 017..... | 9 | 320 072..... | 19 | 322 533..... | 13 |
| 266 578..... | 9 | 269 197..... | 6 | 318 024..... | 9 | 320 089..... | 20 | 322 540..... | 13 |
| 266 585..... | 9 | 269 210..... | 6 | 318 031..... | 10 | 320 096..... | 20 | 322 557..... | 13 |
| 266 592..... | 10 | 269 234..... | 6 | 318 048..... | 7 | 320 102..... | 20 | 322 564..... | 13 |
| 266 608..... | 10 | 269 258..... | 6 | 318 413..... | 14 | 320 119..... | 11 | 335 311..... | 13 |
| 266 615..... | 10 | 269 272..... | 6 | 318 420..... | 14 | 320 133..... | 20 | 348 656..... | 18 |
| 266 622..... | 19 | 269 296..... | 6 | 318 437..... | 14 | 320 188..... | 17 | 348 663..... | 18 |
| 266 639..... | 19 | 271 022..... | 17 | 318 482..... | 14 | 320 195..... | 17 | 348 670..... | 18 |
| 266 646..... | 19 | 271 039..... | 17 | 318 499..... | 14 | 320 201..... | 17 | 348 687..... | 18 |
| 266 653..... | 20 | 271 046..... | 17 | 318 505..... | 14 | 320 218..... | 17 | 348 694..... | 18 |
| 266 660..... | 20 | 271 053..... | 17 | 318 512..... | 14 | 320 225..... | 19 | 348 700..... | 18 |
| 267 247..... | 14 | 271 060..... | 17 | 318 529..... | 14 | 320 232..... | 19 | 348 717..... | 18 |
| 267 254..... | 14 | 271 329..... | 18 | 318 536..... | 14 | 320 249..... | 19 | 354 923..... | 16 |
| 267 261..... | 14 | 271 336..... | 18 | 319 076..... | 13 | 320 256..... | 19 | 354 930..... | 16 |
| 267 278..... | 14 | 271 343..... | 18 | 319 083..... | 13 | 320 263..... | 20 | 354 947..... | 16 |
| 267 285..... | 14 | 271 350..... | 18 | 319 113..... | 11 | 320 270..... | 11 | 354 954..... | 16 |
| 267 292..... | 14 | 271 367..... | 18 | 319 137..... | 9 | 320 287..... | 11 | 354 961..... | 16 |
| 267 308..... | 14 | 271 374..... | 18 | 319 151..... | 20 | 320 294..... | 20 | 354 978..... | 16 |
| 267 315..... | 14 | 271 855..... | 10 | 319 229..... | 15 | 320 409..... | 13 | 354 985..... | 16 |
| 267 322..... | 14 | 271 879..... | 10 | 319 236..... | 15 | 320 416..... | 10 | 354 992..... | 16 |

| Art.-Nr. | Seite | Art.-Nr. | Seite | Art.-Nr. | Seite |
|-----------------|--------------|-----------------|--------------|-----------------|--------------|
| 355 005 | 16 | 441 371 | 11 | 448 288 | 7 |
| 355 012 | 16 | 441 388 | 11 | 449 216 | 14 |
| 355 029 | 16 | 441 395 | 9 | 449 315 | 11 |
| 355 036 | 16 | 441 401 | 10 | 449 322 | 12 |
| 355 043 | 16 | 441 418 | 19 | 449 339 | 12 |
| 355 050 | 16 | 441 425 | 20 | 449 346 | 12 |
| 357 184 | 16 | 441 432 | 17 | 449 414 | 17 |
| 357 191 | 16 | 441 449 | 8 | 458 775 | 12 |
| 357 207 | 16 | 441 456 | 14 | 458 782 | 12 |
| 357 214 | 16 | 441 463 | 14 | 458 799 | 12 |
| 357 221 | 16 | 441 470 | 14 | 458 805 | 12 |
| 357 238 | 16 | 441 487 | 11 | 458 812 | 12 |
| 357 245 | 16 | 441 494 | 11 | 458 829 | 12 |
| 357 252 | 16 | 441 500 | 11 | 458 836 | 12 |
| 357 269 | 16 | 441 517 | 12 | 458 843 | 12 |
| 359 348 | 13 | 441 524 | 12 | 458 850 | 12 |
| 359 539 | 16 | 441 531 | 12 | 576 387 | 6 |
| 359 553 | 16 | 441 548 | 8 | 576 394 | 6 |
| 359 577 | 16 | 441 555 | 14 | 576 400 | 6 |
| 359 584 | 16 | 443 177 | 11 | 581 268 | 6 |
| 362 492 | 9 | 446 666 | 11 | 650 704 | 6 |
| 362 508 | 9 | 446 673 | 11 | 650 803 | 11 |
| 362 515 | 9 | 446 680 | 11 | 651 138 | 17 |
| 362 522 | 9 | 446 697 | 11 | 651 152 | 18 |
| 362 867 | 19 | 446 703 | 11 | | |
| 362 874 | 19 | 446 734 | 11 | | |
| 362 881 | 19 | 446 741 | 11 | | |
| 364 854 | 16 | 446 758 | 11 | | |
| 364 861 | 16 | 446 765 | 12 | | |
| 440 299 | 16 | 446 772 | 12 | | |
| 440 305 | 16 | 446 789 | 12 | | |
| 440 312 | 16 | 446 796 | 12 | | |
| 440 329 | 16 | 446 802 | 12 | | |
| 440 336 | 16 | 446 819 | 12 | | |
| 440 343 | 16 | 446 826 | 12 | | |
| 440 466 | 16 | 446 833 | 12 | | |
| 440 473 | 16 | 446 840 | 12 | | |
| 440 480 | 16 | 446 857 | 12 | | |
| 440 497 | 16 | 446 864 | 12 | | |
| 440 503 | 16 | 446 871 | 17 | | |
| 440 510 | 16 | 446 888 | 17 | | |
| 440 527 | 16 | 446 895 | 17 | | |
| 440 534 | 16 | 446 901 | 17 | | |
| 440 558 | 16 | 446 925 | 17 | | |
| 440 565 | 16 | 446 932 | 17 | | |
| 440 572 | 16 | 446 949 | 17 | | |
| 440 589 | 16 | 446 956 | 17 | | |
| 440 596 | 16 | 446 963 | 17 | | |
| 441 074 | 6 | 446 970 | 17 | | |
| 441 081 | 9 | 446 987 | 17 | | |
| 441 098 | 13 | 446 994 | 18 | | |
| 441 104 | 13 | 447 007 | 18 | | |
| 441 111 | 13 | 447 014 | 18 | | |
| 441 128 | 13 | 447 021 | 18 | | |
| 441 135 | 13 | 447 038 | 18 | | |
| 441 142 | 13 | 447 045 | 18 | | |
| 441 357 | 13 | 447 052 | 18 | | |
| 441 368 | 11 | 448 271 | 7 | | |

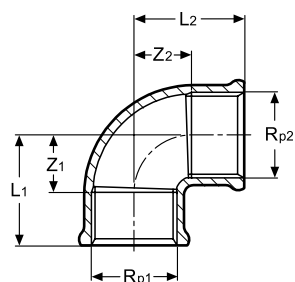

Winkel 90° (IG)

Rotguss
Modell 3090

| Art.-Nr. | Rp1 | Rp2 | L1 | L2 | Z1 | Z2 |
|----------|-------|-------|----|----|----|----|
| 441 074 | 1/8 | 1/8 | 23 | 23 | 15 | 15 |
| 317 959 | 1/4 | 1/4 | 18 | 18 | 11 | 11 |
| 281 717 | 3/8 | 3/8 | 24 | 24 | 16 | 16 |
| 269 272 | 1/2 | 1/2 | 30 | 30 | 20 | 20 |
| 269 258 | 3/4 | 3/4 | 30 | 30 | 19 | 19 |
| 269 234 | 1 | 1 | 38 | 38 | 26 | 26 |
| 269 210 | 1 1/4 | 1 1/4 | 50 | 50 | 36 | 36 |
| 269 197 | 1 1/2 | 1 1/2 | 55 | 55 | 34 | 34 |
| 269 296 | 2 | 2 | 63 | 63 | 45 | 45 |
| 321 796 | 2 1/2 | 2 1/2 | 72 | 72 | 52 | 52 |
| 320 676 | 1/2 | 3/8 | 24 | 26 | 14 | 18 |
| 320 669 | 3/4 | 1/2 | 27 | 30 | 16 | 20 |
| 320 683 | 1 | 3/4 | 33 | 36 | 21 | 25 |

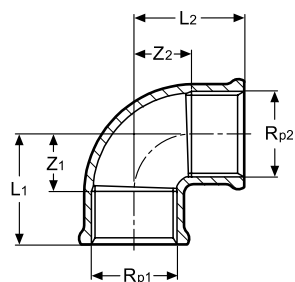

Winkel 90° (IG)

Rotguss
Modell 3090.1

| Art.-Nr. | Rp1 | Rp2 | L1 | L2 | Z1 | Z2 |
|----------|-----|-----|----|----|----|----|
| 576 387 | 1/2 | 1/2 | 34 | 34 | 18 | 18 |

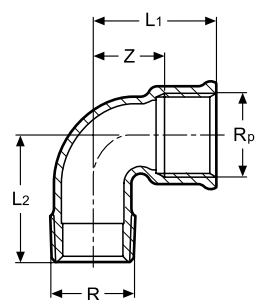

Winkel 90° (AG /IG)

Rotguss
Modell 3092

| Art.-Nr. | R | Rp | L1 | L2 | Z |
|----------|-------|-------|----|-----|----|
| 318 000 | 1/4 | 1/4 | 18 | 29 | 10 |
| 281 748 | 3/8 | 3/8 | 29 | 32 | 17 |
| 264 024 | 1/2 | 1/2 | 24 | 34 | 14 |
| 264 000 | 3/4 | 3/4 | 26 | 38 | 16 |
| 264 048 | 1 | 1 | 32 | 47 | 20 |
| 264 109 | 1 1/4 | 1 1/4 | 43 | 51 | 29 |
| 264 123 | 1 1/2 | 1 1/2 | 60 | 59 | 39 |
| 264 147 | 2 | 2 | 58 | 79 | 40 |
| 321 710 | 2 1/2 | 2 1/2 | 65 | 90 | 45 |
| 650 704 | 3 | 3 | 82 | 100 | 61 |

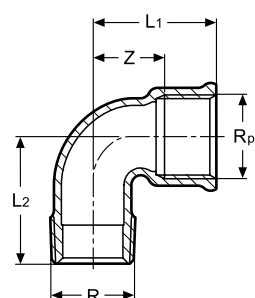

Winkel 90° (AG /IG)

Rotguss
Modell 3092.1

| Art.-Nr. | R | Rp | L1 | L2 | Z |
|----------|-----|-----|----|----|----|
| 581 268 | 1/2 | 1/2 | 24 | 34 | 14 |
| 576 394 | 3/4 | 3/4 | 30 | 40 | 20 |
| 576 400 | 1 | 1 | 46 | 45 | 34 |

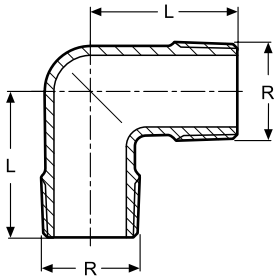

Winkel 90° (AG)

Rotguss
Modell 3091

| Art.-Nr. | R | L |
|----------|---------------|----|
| 317 966 | $\frac{3}{8}$ | 29 |
| 317 973 | $\frac{1}{2}$ | 32 |
| 317 980 | $\frac{3}{4}$ | 40 |
| 317 997 | 1 | 45 |

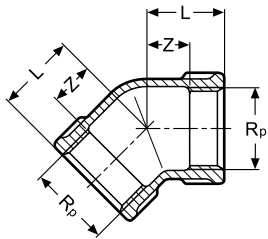

Winkel 45° (IG)

Rotguss
Modell 3120

| Art.-Nr. | Rp | L | Z |
|----------|---------------|----|----|
| 318 048 | $\frac{3}{8}$ | 19 | 12 |
| 320 690 | $\frac{1}{2}$ | 22 | 12 |
| 320 645 | $\frac{3}{4}$ | 25 | 14 |
| 320 652 | 1 | 28 | 16 |

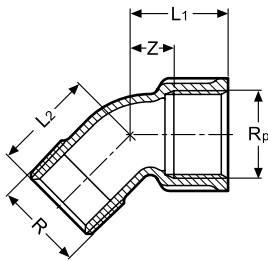

Winkel 45° (AG/IG)

Rotguss
Modell 3121

| Art.-Nr. | R | Rp | L1 | L2 | Z |
|----------|----------------|----------------|----|----|----|
| 281 755 | $\frac{3}{8}$ | $\frac{3}{8}$ | 22 | 23 | 10 |
| 264 208 | $\frac{1}{2}$ | $\frac{1}{2}$ | 23 | 31 | 8 |
| 264 185 | $\frac{3}{4}$ | $\frac{3}{4}$ | 30 | 31 | 13 |
| 264 161 | 1 | 1 | 34 | 35 | 15 |
| 448 271 | $1\frac{1}{4}$ | $1\frac{1}{4}$ | 45 | 40 | 24 |
| 448 288 | $1\frac{1}{2}$ | $1\frac{1}{2}$ | 47 | 45 | 26 |

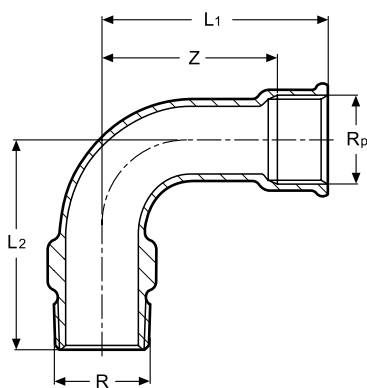

Bogen 90° (AG/IG-Mehrkant)

Rotguss
Modell 3001

| Art.-Nr. | R | Rp | L1 | L2 | Z |
|----------|----------------|----------------|-----|-----|----|
| 294 571 | 1 | 1 | 85 | 75 | 66 |
| 294 595 | $1\frac{1}{4}$ | $1\frac{1}{4}$ | 105 | 95 | 84 |
| 294 618 | $1\frac{1}{2}$ | $1\frac{1}{2}$ | 105 | 105 | 84 |

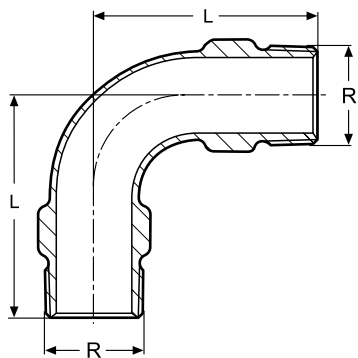

Bogen 90° (AG – Mehrkant)

Rotguss
Modell 3003

| Art.-Nr. | R | L |
|----------|----|-----|
| 294 632 | 1 | 75 |
| 294 656 | 1¼ | 95 |
| 294 670 | 1½ | 105 |

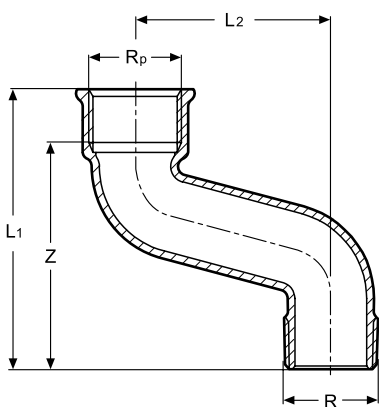

Etagenbogen (AG / IG)

Rotguss
Modell 3004

| Art.-Nr. | R | Rp | L1 | L2 | Z |
|----------|----|----|-----|----|----|
| 296 667 | 1 | 1 | 100 | 70 | 81 |
| 296 643 | 1¼ | 1¼ | 115 | 80 | 94 |

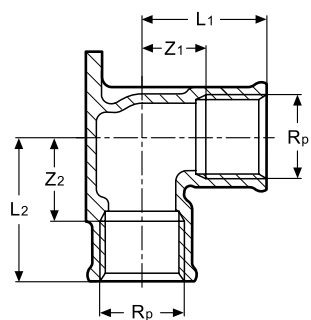

Wandscheibe (IG)

Rotguss
Modell 3471

| Art.-Nr. | Rp | L1 | L2 | Z1 | Z2 |
|----------|----|----|----|----|----|
| 259 778 | ½ | 31 | 36 | 16 | 21 |
| 441 449 | ¾ | 35 | 35 | 19 | 19 |

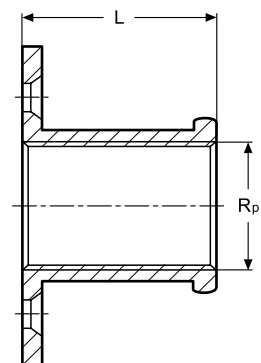

Wandscheibe (IG)

Rotguss
Modell 3472

| Art.-Nr. | Rp | L |
|----------|----|----|
| 441 548 | ½ | 35 |

T-Stück (IG)

Rotguss
Modell 3130

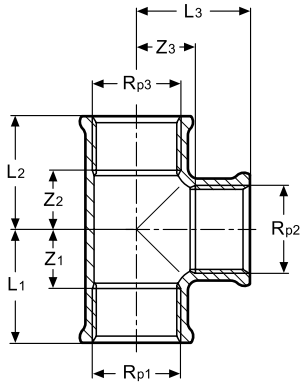

| Art.-Nr. | Rp1 | Rp2 | Rp3 | L1 | L2 | L3 | Z1 | Z2 | Z3 |
|----------|-------|-------|-------|----|----|----|----|----|----|
| 441 081 | 1/8 | 1/8 | 1/8 | 23 | 23 | 23 | 15 | 15 | 15 |
| 318 017 | 1/4 | 1/4 | 1/4 | 18 | 18 | 18 | 11 | 11 | 11 |
| 281 809 | 3/8 | 3/8 | 3/8 | 22 | 22 | 22 | 15 | 15 | 15 |
| 264 222 | 1/2 | 1/2 | 1/2 | 26 | 26 | 26 | 16 | 16 | 16 |
| 264 246 | 3/4 | 3/4 | 3/4 | 30 | 30 | 30 | 19 | 19 | 19 |
| 264 260 | 1 | 1 | 1 | 36 | 36 | 36 | 24 | 24 | 24 |
| 264 284 | 1 1/4 | 1 1/4 | 1 1/4 | 45 | 45 | 45 | 32 | 32 | 32 |
| 264 307 | 1 1/2 | 1 1/2 | 1 1/2 | 54 | 54 | 54 | 33 | 33 | 33 |
| 264 321 | 2 | 2 | 2 | 61 | 61 | 61 | 35 | 35 | 35 |
| 321 734 | 2 1/2 | 2 1/2 | 2 1/2 | 69 | 69 | 69 | 49 | 49 | 49 |
| 321 727 | 3 | 3 | 3 | 85 | 85 | 85 | 63 | 63 | 63 |
| 264 444 | 1/2 | 3/8 | 1/2 | 30 | 30 | 26 | 20 | 20 | 19 |
| 362 492 | 3/4 | 1/2 | 1/2 | 26 | 29 | 26 | 16 | 18 | 16 |
| 264 468 | 3/4 | 1/2 | 3/4 | 30 | 30 | 31 | 20 | 20 | 22 |
| 362 508 | 3/4 | 3/4 | 1/2 | 26 | 30 | 30 | 16 | 19 | 19 |
| 362 515 | 1 | 1/2 | 1 | 31 | 31 | 30 | 19 | 19 | 22 |
| 264 420 | 1 | 3/4 | 1 | 36 | 36 | 36 | 17 | 17 | 20 |
| 362 522 | 1 | 1 | 1/2 | 32 | 37 | 37 | 22 | 25 | 25 |

Kreuzstück (IG)

Rotguss
Modell 3180

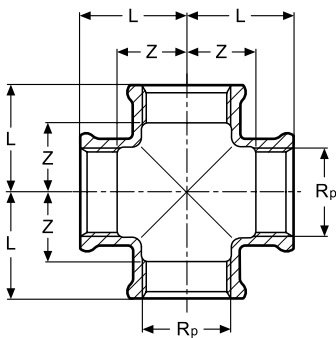

| Art.-Nr. | Rp | L | Z |
|----------|-----|----|----|
| 318 024 | 3/8 | 21 | 14 |
| 320 614 | 1/2 | 27 | 17 |
| 320 621 | 3/4 | 32 | 21 |
| 320 638 | 1 | 38 | 26 |

Muffe (IG)

Rotguss
Modell 3270

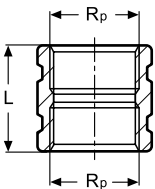

| Art.-Nr. | Rp | L |
|----------|-------|----|
| 441 395 | 1/8 | 16 |
| 319 137 | 1/4 | 18 |
| 282 349 | 3/8 | 23 |
| 266 585 | 1/2 | 30 |
| 266 554 | 3/4 | 33 |
| 266 561 | 1 | 38 |
| 266 578 | 1 1/4 | 43 |
| 267 766 | 1 1/2 | 43 |
| 267 780 | 2 | 59 |
| 271 916 | 2 1/2 | 61 |
| 271 930 | 3 | 67 |

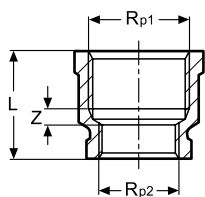

Muffe (Red./IG)

Rotguss
Modell 3240

| Art.-Nr. | Rp1 | Rp2 | L | Z |
|----------|-------|-------|----|----|
| 282 103 | 3/8 | 1/4 | 26 | 3 |
| 318 031 | 1/2 | 1/4 | 31 | 5 |
| 268 879 | 1/2 | 3/8 | 31 | 4 |
| 266 370 | 3/4 | 3/8 | 34 | 5 |
| 268 862 | 3/4 | 1/2 | 32 | 5 |
| 266 363 | 1 | 1/2 | 34 | 13 |
| 266 356 | 1 | 3/4 | 36 | 7 |
| 266 431 | 1 1/4 | 3/4 | 45 | 8 |
| 266 417 | 1 1/4 | 1 | 49 | 6 |
| 271 879 | 1 1/2 | 3/4 | 41 | 10 |
| 267 520 | 1 1/2 | 1 | 48 | 8 |
| 266 394 | 1 1/2 | 1 1/4 | 47 | 5 |
| 271 893 | 2 | 1 1/4 | 50 | 20 |
| 267 544 | 2 | 1 1/2 | 47 | 16 |
| 271 855 | 2 1/2 | 2 | 58 | 22 |

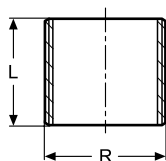

Nippel

Rotguss
Modell 3531

| Art.-Nr. | R | L |
|----------|-------|----|
| 322 076 | 1/4 | 20 |
| 322 113 | 3/8 | 20 |
| 322 106 | 1/2 | 22 |
| 322 090 | 3/4 | 26 |
| 322 083 | 1 | 33 |
| 322 144 | 1 1/4 | 37 |
| 322 137 | 1 1/2 | 42 |
| 322 120 | 2 | 47 |

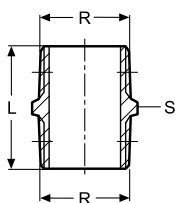

Doppelnippel (AG – Mehrkant)

Rotguss
Modell 3280

| Art.-Nr. | R | L | S |
|----------|-------|----|----|
| 441 401 | 1/8 | 18 | 10 |
| 320 416 | 1/4 | 20 | 14 |
| 282 356 | 3/8 | 29 | 18 |
| 266 592 | 1/2 | 37 | 22 |
| 266 615 | 3/4 | 40 | 27 |
| 266 608 | 1 | 45 | 34 |
| 269 135 | 1 1/4 | 53 | 44 |
| 269 111 | 1 1/2 | 52 | 50 |
| 269 098 | 2 | 65 | 65 |
| 321 741 | 2 1/2 | 78 | 80 |
| 321 789 | 3 | 85 | 95 |

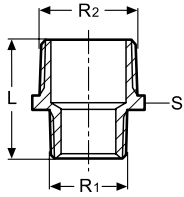

Reduziernippel (AG – Mehrkant)

Rotguss
Modell 3245

| Art.-Nr. | R1 | R2 | L | S |
|----------|-------|-------|----|----|
| 441 368 | 1/4 | 1/8 | 24 | 14 |
| 282 127 | 3/8 | 1/4 | 28 | 18 |
| 319 526 | 1/2 | 1/4 | 31 | 22 |
| 266 530 | 1/2 | 3/8 | 32 | 22 |
| 319 113 | 3/4 | 3/8 | 34 | 27 |
| 266 523 | 3/4 | 1/2 | 37 | 27 |
| 320 287 | 1 | 1/2 | 40 | 34 |
| 266 547 | 1 | 3/4 | 42 | 34 |
| 320 119 | 1 1/4 | 3/4 | 46 | 44 |
| 269 173 | 1 1/4 | 1 | 49 | 44 |
| 321 697 | 1 1/2 | 1 | 52 | 50 |
| 269 159 | 1 1/2 | 1 1/4 | 54 | 50 |
| 441 371 | 1 3/4 | 1 1/2 | 47 | 55 |
| 320 270 | 2 | 1 1/4 | 58 | 60 |
| 321 680 | 2 | 1 1/2 | 59 | 61 |
| 441 388 | 2 3/8 | 2 | 54 | 71 |
| 650 803 | 2 1/2 | 2 | 70 | 76 |
| 443 177 | 3 | 2 1/2 | 77 | 90 |

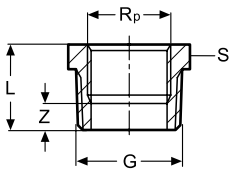

Reduziernippel (AG/IG – Mehrkant)

Rotguss
Modell 3243

| Art.-Nr. | Rp | G | L | Z | S |
|----------|-------|-------|----|----|----|
| 441 487 | 1/4 | 3/8 | 22 | 11 | 18 |
| 446 666 | 3/8 | 1/2 | 23 | 12 | 22 |
| 441 494 | 1/2 | 3/4 | 31 | 16 | 27 |
| 446 673 | 3/4 | 1 | 33 | 16 | 34 |
| 449 315 | 1 | 1 | 41 | 21 | 40 |
| 446 680 | 1 | 1 1/4 | 34 | 15 | 44 |
| 446 697 | 1 1/4 | 1 1/2 | 39 | 18 | 50 |
| 441 500 | 1 1/2 | 1 3/4 | 37 | 16 | 55 |
| 446 703 | 2 | 2 3/8 | 40 | 14 | 70 |

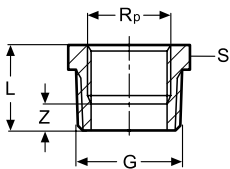

Reduziernippel (AG/IG – Mehrkant)

Rotguss
Modell 3244

| Art.-Nr. | Rp | G | L | Z | S |
|----------|-----|-------|----|----|----|
| 446 734 | 1/2 | 3/4 | 29 | 14 | 27 |
| 446 741 | 3/4 | 1 | 33 | 16 | 34 |
| 446 758 | 1 | 1 1/4 | 34 | 15 | 44 |

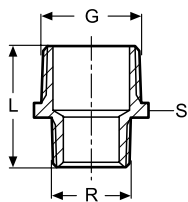

Gewindestutzen (AG – Mehrkant)

Rotguss
Modell 3246

| Art.-Nr. | R | G | L | S |
|----------|----------------|----------------|----|----|
| 449 322 | $\frac{3}{8}$ | $\frac{3}{8}$ | 25 | 17 |
| 441 517 | $\frac{3}{8}$ | $\frac{1}{2}$ | 25 | 22 |
| 449 339 | $\frac{1}{2}$ | $\frac{1}{2}$ | 30 | 22 |
| 441 524 | $\frac{1}{2}$ | $\frac{3}{4}$ | 21 | 27 |
| 449 346 | $\frac{3}{4}$ | $\frac{3}{4}$ | 33 | 28 |
| 446 765 | $\frac{1}{2}$ | 1 | 33 | 34 |
| 441 531 | $\frac{3}{4}$ | 1 | 35 | 34 |
| 446 772 | 1 | 1 | 39 | 34 |
| 446 789 | 1 | $1\frac{1}{4}$ | 39 | 44 |
| 446 796 | $1\frac{1}{4}$ | $1\frac{1}{2}$ | 45 | 50 |
| 446 802 | $1\frac{1}{2}$ | $1\frac{3}{4}$ | 47 | 55 |
| 446 819 | 2 | $2\frac{3}{8}$ | 58 | 70 |
| 446 826 | $2\frac{1}{2}$ | 3 | 64 | 90 |

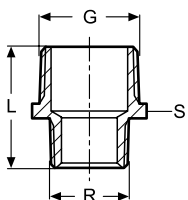

Gewindestutzen (AG – Mehrkant)

Rotguss
Modell 3247

| Art.-Nr. | R | G | L | S |
|----------|----------------|----------------|----|----|
| 458 775 | $\frac{3}{8}$ | $\frac{1}{4}$ | 20 | 14 |
| 458 782 | $\frac{1}{4}$ | $\frac{3}{8}$ | 24 | 18 |
| 458 799 | $\frac{1}{4}$ | $\frac{1}{2}$ | 25 | 22 |
| 458 805 | $\frac{3}{8}$ | $\frac{1}{2}$ | 24 | 27 |
| 458 812 | $\frac{3}{8}$ | $\frac{3}{4}$ | 28 | 27 |
| 446 833 | $\frac{1}{2}$ | $\frac{3}{4}$ | 31 | 27 |
| 458 829 | $\frac{1}{2}$ | 1 | 30 | 34 |
| 446 840 | $\frac{3}{4}$ | 1 | 35 | 34 |
| 458 836 | $\frac{3}{4}$ | $1\frac{1}{4}$ | 38 | 44 |
| 446 857 | 1 | $1\frac{1}{4}$ | 37 | 44 |
| 446 864 | 1 | $1\frac{1}{2}$ | 45 | 50 |
| 458 843 | $1\frac{1}{4}$ | $1\frac{1}{2}$ | 43 | 50 |
| 458 850 | $1\frac{1}{2}$ | 2 | 48 | 68 |

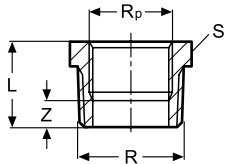

Reduzierstück (AG / IG – Mehrkant)

Rotguss
Modell 3241

| Art.-Nr. | R | Rp | L | Z | S |
|----------|-------|-------|----|----|-----|
| 441 104 | 1/4 | 1/8 | 17 | - | 14 |
| 441 111 | 3/8 | 1/8 | 17 | 10 | 18 |
| 281 823 | 3/8 | 1/4 | 17 | - | 18 |
| 441 098 | 1/2 | 1/8 | 21 | 15 | 22 |
| 319 076 | 1/2 | 1/4 | 22 | 11 | 22 |
| 266 516 | 1/2 | 3/8 | 22 | - | 22 |
| 320 409 | 3/4 | 1/4 | 23 | 14 | 27 |
| 266 509 | 3/4 | 3/8 | 23 | 14 | 27 |
| 266 493 | 3/4 | 1/2 | 23 | - | 27 |
| 266 455 | 1 | 3/8 | 27 | 11 | 34 |
| 266 486 | 1 | 1/2 | 28 | 14 | 34 |
| 266 479 | 1 | 3/4 | 28 | - | 34 |
| 267 582 | 1 1/4 | 1/2 | 31 | 22 | 43 |
| 267 568 | 1 1/4 | 3/4 | 31 | 17 | 44 |
| 266 462 | 1 1/4 | 1 | 31 | - | 44 |
| 267 742 | 1 1/2 | 1/2 | 32 | 24 | 50 |
| 267 728 | 1 1/2 | 3/4 | 31 | 17 | 50 |
| 267 605 | 1 1/2 | 1 | 31 | 19 | 50 |
| 267 704 | 1 1/2 | 1 1/4 | 31 | - | 50 |
| 317 089 | 2 | 1/2 | 36 | 21 | 62 |
| 267 681 | 2 | 3/4 | 36 | 25 | 62 |
| 267 667 | 2 | 1 | 37 | 23 | 60 |
| 267 643 | 2 | 1 1/4 | 37 | 22 | 61 |
| 267 629 | 2 | 1 1/2 | 37 | 21 | 61 |
| 321 772 | 2 1/2 | 1 | 45 | 33 | 80 |
| 321 765 | 2 1/2 | 1 1/4 | 41 | 26 | 78 |
| 321 864 | 2 1/2 | 1 1/2 | 41 | 26 | 78 |
| 322 533 | 2 1/2 | 2 | 41 | 23 | 78 |
| 321 840 | 3 | 1 1/2 | 52 | 35 | 60 |
| 321 857 | 3 | 2 | 54 | 35 | 72 |
| 321 871 | 3 | 2 1/2 | 50 | 29 | 95 |
| 321 888 | 4 | 3 | 56 | 35 | 125 |

Reduzierstück (AG / IG)

Rotguss
Modell 3242

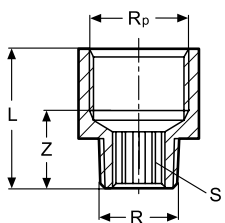

| Art.-Nr. | R | Rp | L | Z | S |
|----------|-----|-------|----|----|----|
| 441 128 | 1/8 | 1/4 | 25 | 14 | 6 |
| 441 135 | 1/8 | 3/8 | 26 | 15 | 6 |
| 322 540 | 1/4 | 3/8 | 27 | 15 | - |
| 322 564 | 3/8 | 1/2 | 32 | 17 | 10 |
| 322 557 | 3/8 | 3/4 | 35 | 19 | 10 |
| 320 423 | 1/2 | 3/4 | 37 | 21 | 12 |
| 319 083 | 1/2 | 3/8 | 28 | 17 | 10 |
| 320 430 | 1/2 | 1 | 39 | 19 | - |
| 441 142 | 3/4 | 1/2 | 40 | 25 | - |
| 335 311 | 3/4 | 1 | 42 | 23 | 17 |
| 441 357 | 3/4 | 1 1/4 | 52 | 31 | - |
| 359 348 | 1 | 1 1/4 | 48 | 27 | - |

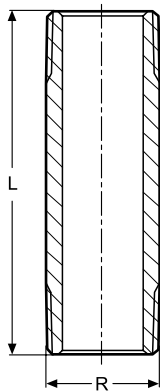

Langnippel (AG)

Rotguss
Modell 3530

| Art.-Nr. | R | L |
|----------|----|-----|
| 441 456 | ¼ | 38 |
| 441 463 | ¼ | 58 |
| 441 470 | ¼ | 78 |
| 441 555 | ¼ | 98 |
| 282 400 | ⅜ | 38 |
| 282 417 | ⅜ | 58 |
| 282 424 | ⅜ | 78 |
| 282 431 | ⅜ | 98 |
| 282 448 | ⅜ | 118 |
| 282 455 | ⅜ | 148 |
| 282 462 | ⅜ | 198 |
| 267 308 | ½ | 38 |
| 267 315 | ½ | 58 |
| 449 216 | ½ | 68 |
| 267 322 | ½ | 78 |
| 267 339 | ½ | 98 |
| 267 346 | ½ | 118 |
| 319 700 | ½ | 138 |
| 267 353 | ½ | 148 |
| 319 717 | ½ | 158 |
| 319 724 | ½ | 178 |
| 267 377 | ½ | 198 |
| 267 384 | ¾ | 38 |
| 267 391 | ¾ | 58 |
| 267 407 | ¾ | 78 |
| 267 414 | ¾ | 98 |
| 267 421 | ¾ | 118 |
| 318 413 | ¾ | 138 |
| 267 438 | ¾ | 148 |
| 318 420 | ¾ | 158 |
| 318 437 | ¾ | 178 |
| 267 445 | ¾ | 198 |
| 267 247 | 1 | 38 |
| 267 254 | 1 | 58 |
| 267 261 | 1 | 78 |
| 267 278 | 1 | 98 |
| 267 285 | 1 | 118 |
| 267 292 | 1 | 148 |
| 319 694 | 1 | 198 |
| 318 482 | 1¼ | 58 |
| 318 499 | 1¼ | 78 |
| 318 505 | 1¼ | 98 |
| 318 512 | 1¼ | 118 |
| 318 529 | 1¼ | 148 |
| 318 536 | 1¼ | 198 |
| 319 755 | 1½ | 58 |
| 319 762 | 1½ | 78 |
| 319 779 | 1½ | 98 |

Fortsetzung siehe nächste Seite

Langnippel (AG)

Rotguss
Modell 3530

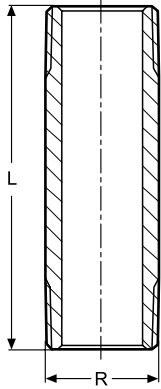

| Art.-Nr. | R | L |
|----------|----|-----|
| 319 786 | 1½ | 118 |
| 319 748 | 1½ | 148 |
| 319 731 | 1½ | 198 |
| 319 847 | 2 | 58 |
| 319 830 | 2 | 78 |
| 319 823 | 2 | 98 |
| 319 816 | 2 | 118 |
| 319 809 | 2 | 148 |
| 319 793 | 2 | 198 |

Langnippel (Innenvielkant)

Rotguss
Modell 3535

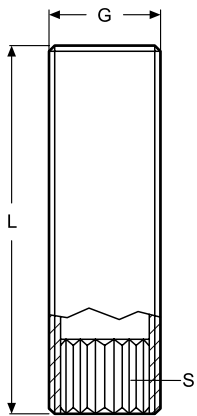

| Art.-Nr. | G | L | S |
|----------|---|-----|----|
| 319 670 | ¾ | 38 | 10 |
| 319 267 | ¾ | 58 | 10 |
| 319 335 | ¾ | 78 | 10 |
| 319 281 | ¾ | 98 | 10 |
| 319 687 | ¾ | 118 | 10 |
| 319 274 | ½ | 38 | 12 |
| 319 366 | ½ | 58 | 12 |
| 319 359 | ½ | 78 | 12 |
| 319 342 | ½ | 98 | 12 |
| 319 656 | ½ | 118 | 12 |
| 319 328 | ¾ | 38 | 17 |
| 319 298 | ¾ | 58 | 17 |
| 319 304 | ¾ | 78 | 17 |
| 319 311 | ¾ | 98 | 17 |
| 319 663 | ¾ | 118 | 17 |
| 319 250 | 1 | 38 | 22 |
| 319 243 | 1 | 58 | 22 |
| 319 236 | 1 | 78 | 22 |
| 319 229 | 1 | 98 | 22 |
| 319 649 | 1 | 118 | 22 |

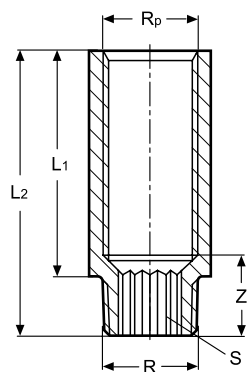

Hahnverlängerung (Innenvielkant)

Rotguss
Modell 3525

| Art.-Nr. | R | Rp | L1 | L2 | Z | S |
|----------|-------|-------|------|-----|----|----|
| 440 312* | 3/8 | 3/8 | 10 | 20 | 14 | 10 |
| 354 923 | 3/8 | 3/8 | 15 | 25 | 14 | 10 |
| 354 930 | 3/8 | 3/8 | 20 | 30 | 16 | 10 |
| 354 947 | 3/8 | 3/8 | 25 | 35 | 16 | 10 |
| 354 954 | 3/8 | 3/8 | 30 | 40 | 16 | 10 |
| 359 539 | 3/8 | 3/8 | 40 | 50 | 15 | 10 |
| 359 553 | 3/8 | 3/8 | 50 | 60 | 15 | 10 |
| 440 329 | 3/8 | 3/8 | 65 | 75 | 14 | 10 |
| 440 336 | 3/8 | 3/8 | 80 | 90 | 30 | 10 |
| 440 343 | 3/8 | 3/8 | 100 | 110 | 45 | 10 |
| 364 854* | 1/2 | 1/2 | 12,5 | 26 | 19 | 12 |
| 354 961 | 1/2 | 1/2 | 17,5 | 31 | 19 | 12 |
| 354 978 | 1/2 | 1/2 | 20 | 33 | 18 | 12 |
| 354 985 | 1/2 | 1/2 | 25 | 38 | 19 | 12 |
| 354 992 | 1/2 | 1/2 | 30 | 43 | 19 | 12 |
| 355 005 | 1/2 | 1/2 | 40 | 53 | 19 | 12 |
| 355 012 | 1/2 | 1/2 | 50 | 63 | 18 | 12 |
| 357 221 | 1/2 | 1/2 | 65 | 78 | 18 | 12 |
| 357 238 | 1/2 | 1/2 | 80 | 93 | 26 | 12 |
| 357 245 | 1/2 | 1/2 | 100 | 113 | 58 | 12 |
| 440 299 | 1/2 | 1/2 | 120 | 133 | 68 | 12 |
| 440 305 | 1/2 | 1/2 | 150 | 163 | 98 | 12 |
| 440 558* | 3/4 | 3/4 | 13 | 27 | 19 | 17 |
| 364 861* | 3/4 | 3/4 | 15 | 30 | 21 | 17 |
| 355 029 | 3/4 | 3/4 | 20 | 35 | 18 | 17 |
| 355 036 | 3/4 | 3/4 | 25 | 40 | 23 | 17 |
| 355 043 | 3/4 | 3/4 | 30 | 45 | 21 | 17 |
| 355 050 | 3/4 | 3/4 | 40 | 55 | 21 | 17 |
| 357 252 | 3/4 | 3/4 | 50 | 65 | 20 | 17 |
| 357 269 | 3/4 | 3/4 | 65 | 80 | 20 | 17 |
| 359 584 | 3/4 | 3/4 | 80 | 95 | 35 | 17 |
| 359 577 | 3/4 | 3/4 | 100 | 115 | 60 | 17 |
| 440 565 | 3/4 | 3/4 | 120 | 135 | 70 | 17 |
| 440 572* | 1 | 1 | 15 | 35 | 25 | 22 |
| 440 589* | 1 | 1 | 20 | 40 | 25 | 22 |
| 357 184 | 1 | 1 | 25 | 45 | 28 | 22 |
| 357 191 | 1 | 1 | 30 | 50 | 31 | 22 |
| 357 207 | 1 | 1 | 40 | 60 | 25 | 22 |
| 357 214 | 1 | 1 | 50 | 70 | 25 | 22 |
| 440 596 | 1 | 1 | 65 | 85 | 25 | 22 |
| 440 466 | 1 | 1 | 80 | 100 | 40 | 22 |
| 440 473 | 1 | 1 | 100 | 120 | 55 | 22 |
| 440 480* | 1 1/4 | 1 1/4 | 15 | 37 | 27 | 27 |
| 440 497* | 1 1/4 | 1 1/4 | 20 | 42 | 27 | 27 |
| 440 503 | 1 1/4 | 1 1/4 | 25 | 47 | 27 | 27 |
| 440 510 | 1 1/4 | 1 1/4 | 30 | 52 | 27 | 27 |
| 440 527 | 1 1/4 | 1 1/4 | 40 | 62 | 41 | 27 |
| 440 534 | 1 1/4 | 1 1/4 | 50 | 72 | 51 | 27 |

* = ohne DVGW-Prüfzeichen

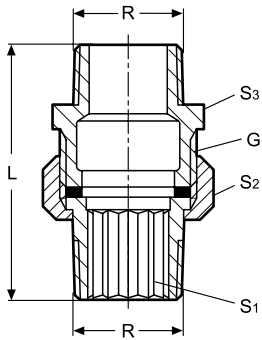

Rohrverschraubung (AG – flachdichtend)

Rotguss
Modell 3334

| Art.-Nr. | R | G | L | S1 | S2 | S3 |
|----------|-----|-------|----|----|----|----|
| 320 188 | 3/8 | 1/2 | 51 | 8 | 23 | 27 |
| 320 195 | 1/2 | 3/4 | 62 | 12 | 29 | 27 |
| 320 201 | 3/4 | 1 | 68 | 17 | 36 | 34 |
| 320 218 | 1 | 1 1/4 | 74 | 22 | 46 | 44 |

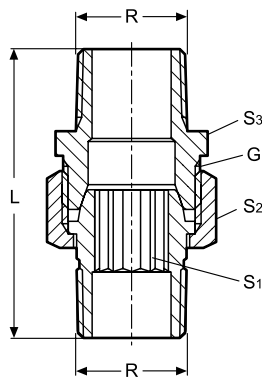

Rohrverschraubung (AG – konischdichtend)

Rotguss
Modell 3344

| Art.-Nr. | R | G | L | S1 | S2 | S3 |
|----------|-----|-------|----|----|----|----|
| 446 871 | 3/8 | 1/2 | 47 | 8 | 23 | 22 |
| 446 888 | 1/2 | 3/4 | 55 | 12 | 29 | 27 |
| 446 895 | 3/4 | 1 | 62 | 17 | 36 | 34 |
| 446 901 | 1 | 1 1/4 | 69 | 22 | 46 | 44 |

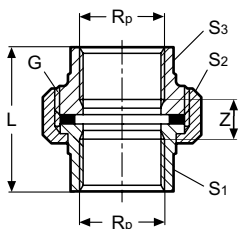

Rohrverschraubung (IG – flachdichtend)

Rotguss
Modell 3330

| Art.-Nr. | Rp | G | L | Z | S1 | S2 | S3 |
|----------|-------|-------|----|----|----|-----|----|
| 441 432 | 1/4 | 3/4 | 35 | 13 | 20 | 29 | 20 |
| 282 363 | 3/8 | 3/4 | 35 | 12 | 21 | 29 | 20 |
| 271 022 | 1/2 | 1 | 41 | 11 | 25 | 36 | 25 |
| 271 039 | 3/4 | 1 1/4 | 44 | 11 | 32 | 46 | 32 |
| 271 046 | 1 | 1 1/2 | 51 | 27 | 39 | 52 | 39 |
| 271 053 | 1 1/4 | 2 | 56 | 29 | 47 | 65 | 48 |
| 271 060 | 1 1/2 | 2 3/8 | 58 | 31 | 55 | 75 | 53 |
| 651 138 | 2 1/2 | 3 1/2 | 71 | 33 | 83 | 110 | 83 |

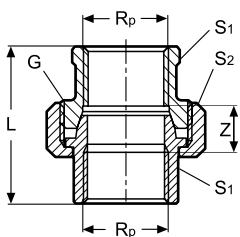

Rohrverschraubung (IG – konischdichtend)

Rotguss
Modell 3340

| Art.-Nr. | Rp | G | L | Z | S1 | S2 | S3 |
|----------|-------|-------|----|----|----|----|----|
| 449 414 | 1/4 | 1/2 | 38 | 16 | – | 23 | – |
| 446 925 | 3/8 | 3/4 | 40 | 17 | – | 29 | – |
| 446 932 | 1/2 | 1 | 47 | 15 | – | 36 | – |
| 446 949 | 3/4 | 1 1/4 | 50 | 15 | – | 46 | – |
| 446 956 | 1 | 1 1/2 | 60 | 21 | 37 | 52 | 37 |
| 446 963 | 1 1/4 | 2 | 65 | 22 | 47 | 65 | 48 |
| 446 970 | 1 1/2 | 2 3/8 | 68 | 25 | 55 | 75 | 55 |
| 446 987 | 2 | 2 1/2 | 74 | 23 | 68 | 80 | 66 |

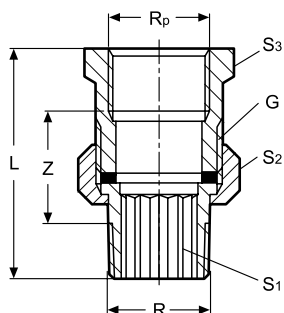

Rohrverschraubung (AG/IG – flachdichtend)

Rotguss
Modell 3331

| Art.-Nr. | R/Rp | G | L | Z | S1 | S2 | S3 |
|----------|-------|-------|----|----|----|----|----|
| 282 370 | 3/8 | 1/2 | 50 | 29 | 8 | 23 | 22 |
| 271 374 | 1/2 | 3/4 | 60 | 33 | 12 | 29 | 27 |
| 271 367 | 3/4 | 1 | 66 | 36 | 17 | 36 | 34 |
| 271 350 | 1 | 1 1/4 | 72 | 37 | 22 | 46 | 44 |
| 271 343 | 1 1/4 | 1 1/2 | 81 | 41 | 38 | 52 | 50 |
| 271 336 | 1 1/2 | 1 3/4 | 84 | 43 | 43 | 59 | 56 |
| 271 329 | 2 | 2 3/8 | 84 | 35 | 58 | 75 | 68 |
| 651 152 | 2 1/2 | 3 | 88 | 66 | 83 | 95 | 71 |

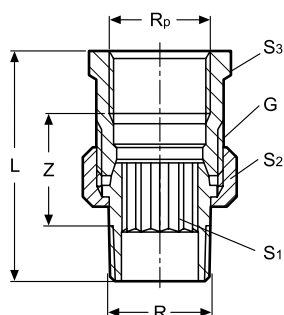

Rohrverschraubung (AG/IG – konischdichtend)

Rotguss
Modell 3341

| Art.-Nr. | R/Rp | G | L | Z | S1 | S2 | S3 |
|----------|-------|-------|----|----|----|----|----|
| 446 994 | 3/8 | 1/2 | 45 | 23 | 8 | 23 | 22 |
| 447 007 | 1/2 | 3/4 | 56 | 28 | 12 | 29 | 27 |
| 447 014 | 3/4 | 1 | 60 | 29 | 17 | 36 | 34 |
| 447 021 | 1 | 1 1/4 | 64 | 28 | 22 | 46 | 44 |
| 447 038 | 1 1/4 | 1 1/2 | 72 | 32 | – | 52 | 50 |
| 447 045 | 1 1/2 | 1 3/4 | 73 | 33 | – | 59 | 55 |
| 447 052 | 2 | 2 3/8 | 78 | 29 | – | 75 | 70 |

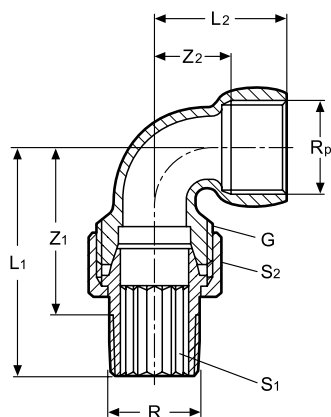

Winkelverschraubung (AG/IG – konischdichtend)

Rotguss
Modell 3098

| Art.-Nr. | R/Rp | G | L1 | L2 | Z1 | Z2 | S1 | S2 |
|----------|------|-----|----|----|----|----|----|----|
| 148 041 | 3/8 | 1/2 | 45 | 28 | 35 | 16 | 8 | 23 |
| 145 804 | 1/2 | 3/4 | 51 | 33 | 38 | 18 | 12 | 29 |

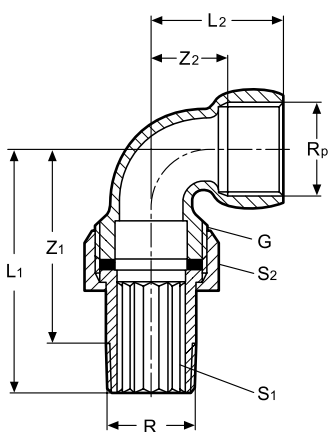

Winkelverschraubung (AG/IG – flachdichtend)

Rotguss
Modell 3088

| Art.-Nr. | R/Rp | G | L1 | L2 | Z1 | Z2 | S1 | S2 |
|----------|-------|-------|-----|----|----|----|----|----|
| 348 656 | 3/8 | 1/2 | 50 | 28 | 39 | 14 | 8 | 23 |
| 348 663 | 1/2 | 3/4 | 58 | 33 | 44 | 16 | 12 | 29 |
| 348 670 | 3/4 | 1 | 65 | 39 | 51 | 20 | 17 | 36 |
| 348 687 | 1 | 1 1/4 | 78 | 47 | 60 | 25 | 22 | 46 |
| 348 694 | 1 1/4 | 1 1/2 | 83 | 57 | 65 | 35 | 38 | 52 |
| 348 700 | 1 1/2 | 1 3/4 | 95 | 59 | 75 | 38 | 43 | 59 |
| 348 717 | 2 | 2 3/8 | 112 | 69 | 87 | 43 | – | 75 |

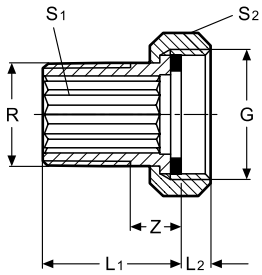

Verschraubung (AG – flachdichtend)

Rotguss
Modell 3335

| Art.-Nr. | R | G | L1 | L2 | Z | S1 | S2 |
|----------|-------|-------|----|----|----|----|----|
| 320 225 | 3/8 | 1/2 | 27 | 6 | 17 | 8 | 23 |
| 320 232 | 1/2 | 3/4 | 31 | 7 | 19 | 12 | 29 |
| 320 249 | 3/4 | 1 | 34 | 8 | 20 | 17 | 36 |
| 320 256 | 1 | 1 1/4 | 38 | 8 | 22 | 22 | 46 |
| 319 618 | 1 1/4 | 1 1/2 | 43 | 9 | 24 | 38 | 52 |
| 319 625 | 1 1/2 | 1 3/4 | 46 | 10 | 27 | 43 | 59 |
| 319 632 | 2 | 2 3/8 | 52 | 10 | 29 | 58 | 75 |

Flansch PN 16 (IG)

Rotguss
Modell 2259.2XL

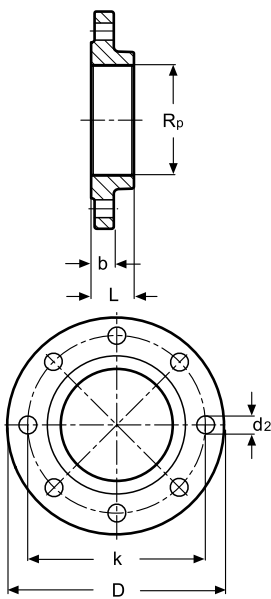

| Art.-Nr. | Flansch-Nennweite | Rp | D | L | b | d2 | k | n |
|----------|-------------------|-------|-----|----|----|----|-----|---|
| 362 867 | DN 65 | 2 1/2 | 185 | 32 | 18 | 18 | 145 | 8 |
| 362 874 | DN 80 | 3 | 200 | 34 | 20 | 18 | 160 | 8 |
| 362 881 | DN 100 | 4 | 220 | 38 | 20 | 18 | 180 | 8 |

Stopfen (AG – Vierkant)

Rotguss
Modell 3291

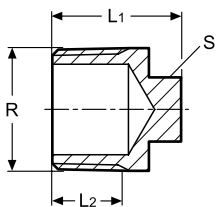

L2 = nutzbare Gewindelänge

| Art.-Nr. | R | L1 | L2 | S |
|----------|-------|----|----|----|
| 441 418 | 1/8 | 17 | 7 | 8 |
| 320 072 | 1/4 | 19 | 10 | 8 |
| 281 847 | 3/8 | 20 | 10 | 10 |
| 266 646 | 1/2 | 26 | 13 | 12 |
| 266 639 | 3/4 | 28 | 15 | 14 |
| 266 622 | 1 | 32 | 17 | 14 |
| 268 237 | 1 1/4 | 38 | 19 | 21 |
| 268 190 | 1 1/2 | 38 | 19 | 22 |
| 268 213 | 2 | 42 | 24 | 26 |
| 321 758 | 2 1/2 | 47 | 27 | 30 |

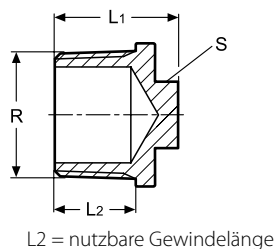

Stopfen (AG – Vierkant)

Rotguss
Modell 3290

| Art.-Nr. | R | L1 | L2 | S |
|----------|-------|----|----|----|
| 441 425 | 1/8 | 17 | 8 | 8 |
| 320 133 | 1/4 | 20 | 12 | 8 |
| 320 096 | 3/8 | 20 | 12 | 10 |
| 320 102 | 1/2 | 24 | 16 | 12 |
| 320 089 | 3/4 | 26 | 17 | 14 |
| 320 294 | 1 | 32 | 20 | 14 |
| 322 175 | 1 1/4 | 38 | 22 | 21 |
| 322 168 | 1 1/2 | 38 | 22 | 32 |
| 322 151 | 2 | 42 | 27 | 26 |

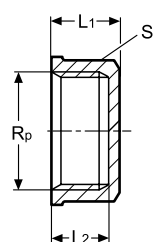

Kappe (IG – Mehrkant)

Rotguss
Modell 3301

| Art.-Nr. | Rp | L1 | L2 | S |
|----------|-------|----|----|----|
| 319 151 | 1/4 | 12 | 10 | 20 |
| 281 854 | 3/8 | 16 | 14 | 22 |
| 266 660 | 1/2 | 20 | 18 | 24 |
| 266 653 | 3/4 | 16 | 19 | 30 |
| 268 367 | 1 | 29 | 23 | 38 |
| 268 305 | 1 1/4 | 30 | 28 | 47 |
| 268 329 | 1 1/2 | 30 | 25 | 54 |
| 268 343 | 2 | 34 | 29 | 65 |

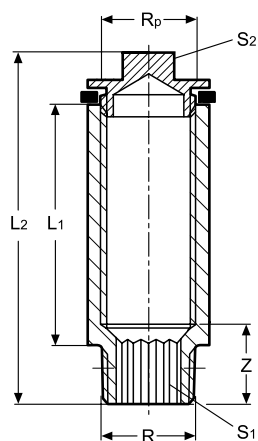

Bauelement (mit Stopfen)

Rotguss
Modell 3527

| Art.-Nr. | R | Rp | L1 | L2 | Z | S | S1 |
|----------|-----|-----|----|----|----|----|----|
| 320 263 | 1/2 | 1/2 | 50 | 76 | 18 | 12 | 12 |